

MSA

MEDICAL
SPECIALTIES
AUSTRALASIA

pfmmedical

Quality and Experience

ASEPT™-System

- › ASEPT™ Pleural/Peritoneal Drainage System
- › ASEPT™ Drainage Kits (600 ml + 1,200 ml)
- › Accessories

Recurring pleural effusions or malignant ascites can be treated on an outpatient basis using the ASEPT™ system.¹

www.pfmmedical.com



Recurring pleural effusions or malignant ascites can be treated on an outpatient basis using the **ASEPT™ system**.

A tunnelled permanent drainage catheter is implanted in the pleural cavity (pleural effusion) or in the peritoneal cavity (ascites). After completion of this surgical intervention, the patient is able to return home. The drainage is carried out there every 1 - 2 days in accordance with instructions provided by the physician.

General Benefits

Improved quality of life

The direct symptoms, e.g. dyspnoea, already improve during the drainage. A spontaneous pleurodesis occurs within one month in 59% of the cases.¹ Drainage using the ASEPT™ system is almost painless, when compared with other forms of treatment, e.g. chemical pleurodesis.

Outpatient drainage

The drainage can be carried out by the patient, relatives or a nursing care service. They will be trained by examined nursing staff from pfm medical. Drainage bottles are sent direct to the patient.

Minimally invasive

The catheter is inserted in the pleural or peritoneal cavity by means of the Seldinger technique - this minimises the risk of internal organs being injured. The intervention which is carried out under a local anaesthetic can take place whether as an inpatient or as an outpatient.

Safe

The treatment has a low infection rate. On the one hand, the tunnelled application of the catheter provides an effective infection barrier and on the other, the drainage bottles which are under negative pressure prevent contaminated fluids from penetrating the effusion space.

ASEPT™ Pleural/Peritoneal Drainage System

The ASEPT™ Pleural/Peritoneal Drainage System includes all of the components which are required for a tunnelled insertion of the ASEPT™ permanent drainage catheter using the Seldinger technique.

View

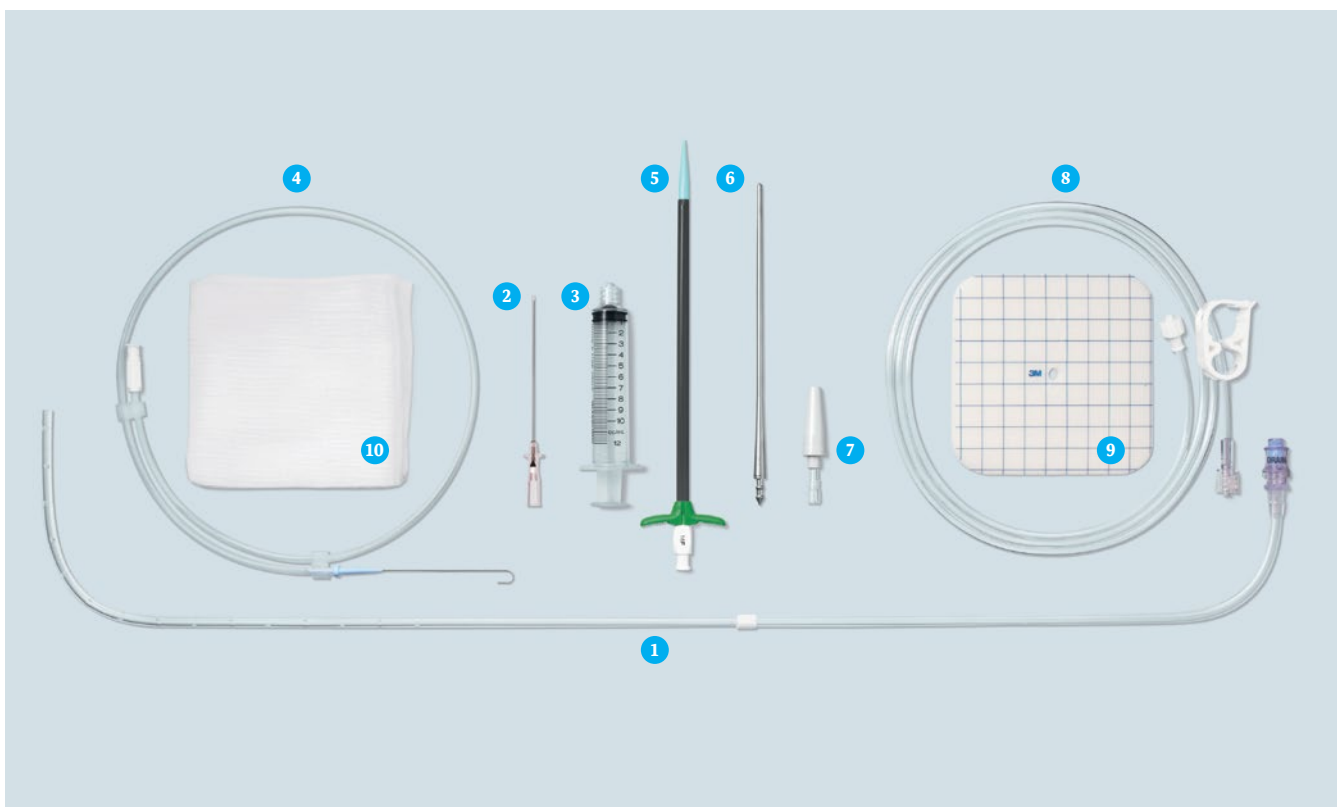

- 1 ASEPT™ drainage catheter (15 Fr)
- 2 Guide wire insertion needle (18 G)
- 3 10 ml syringe
- 4 Guide wire with J-end
- 5 Split cannula (16 Fr)
- 6 Tunneler
- 7 5-in-1 drainage tube adapter
- 8 ASEPT™ drainage tube
- 9 Foam catheter pad
- 10 Gauze compress (10 x 10 cm)

Benefits

Safety valve

The ASEPT™ valve closes automatically, is easy to clean and connects the catheter with the drainage bottle in an especially hygienic way. No end caps or fixations are required. The valve even works without play and safely after numerous connections have been made.

Minimised dislocation risk

A polyester cuff is positioned in the tunnel subcutaneously, adheres and thereby minimises the dislocation risk.

Detailed View



Tech. Data

Catheter

- ▶ **Length:** 66 cm (pleural) or 71 cm (peritoneal)
- ▶ **Material:** silicone
- ▶ **X-Ray contrast strip**

Application Range

The **ASEPT™ Pleural Drainage System** serves the long-term regular drainage of symptomatic recurring pleural effusions, including malignant pleural effusions and other pleural effusions which do not respond to treatment.

The **ASEPT™ Peritoneal Drainage System** serves the regular drainage of recurring and symptomatic malignant ascites. The catheter is designed for the gaining of long-term access to the peritoneal cavity in order to relieve symptoms such as dyspnoea.

Ordering Information

ASEPT™ Pleural Drainage System

REF	PU
P09080001	1

ASEPT™ Peritoneal Drainage System

REF	PU
P09080002	1

ASEPT™ Drainage Kits (600 ml + 1,200 ml)

The ASEPT™ Drainage Kits enable pleural effusions be drained on an outpatient basis. The kits are available in two sizes (600 ml + 1,200 ml) including all of the consumables which are required to ensure a hygienic drainage.

View

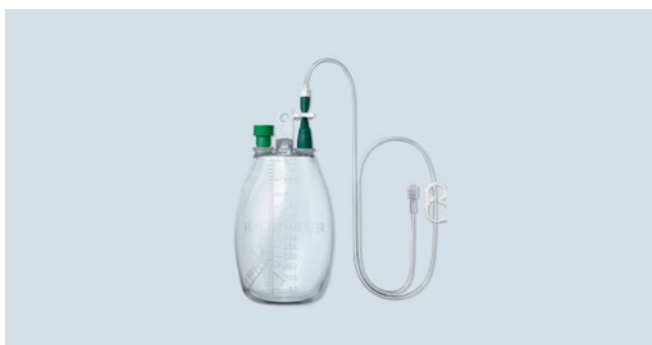

ASEPT™ Drainage Kit, 600 ml volume
(drainage of pleural effusions)



ASEPT™ Two-Bottle Drainage Kit, 1,200 ml volume
(drainage of ascites)

Benefits

Safely pre-evacuated

The bottles have been pre-evacuated and are under negative pressure. The effusion fluid is simply suctioned by it being connected to the ASEPT™ catheter. A vacuum indicator displays the functionality of the bottle. No additional devices are required for the drainage.

Fast delivery

The ASEPT™ drainage kits are delivered to the patient on the same day if we receive notification by 1.00 p.m.

Complete

The ASEPT™ Drainage Kits include sterile consumables which can be used to sterilise the valve and cover the ASEPT™ catheter.

Detailed View



Sterile consumables



Vacuum indicator

- 1 vacuum intact
- 2 vacuum not intact

Details

Sterile consumables

- ▶ Gloves
- ▶ Alcohol swab
- ▶ Foam catheter pad

- ▶ Gauze compress
- ▶ Emergency clamp (not shown)
- ▶ Self-adhesive surgical dressing

Ordering Information

ASEPT™ Drainage Kit, 600 ml

REF	PU
P09080003	10

ASEPT™ Two-Bottle Drainage Kit, 1,200 ml

REF	PU
P09080004	5

Ordering Information Accessories

ASEPT™ Replacement Valve › A damaged valve can be easily replaced with an ASEPT™ replacement valve.

REF	PU
P09080005	5

ASEPT™ Drainage Line Set › The ASEPT™ drainage line set can be used to connect the ASEPT™ drainage catheter to a wall suction, for example. A 5-in-1-adapter is included.

REF	PU
P09080006	10

¹ Warren et al., European Journal of Cardio-thoracic Surgery 33 (2008) 89-94

Contact

Should you have any questions our Customer Solutions Team is happy to advise you.

tpm@pfmmedical.com
 T +49 (0)2236 9641-530
 F +49 (0)2236 9641-9950



MEDICAL
SPECIALTIES
AUSTRALASIA

54 Gibbes St, Chatswood 2067 NSW, Australia
 PO Box 764, Willoughby 2068 NSW, Australia

✉ custserv@msa.com.au ☎ 02 9417 7955
 🌐 www.msa.com.au 📞 02 9417 5779

www.pfmmedical.com - Your information source for the products of pfm medical ag.

pfmmedical

EC REP

pfm medical ag
 Distributor
 pfm medical tpm gmbh
 Wankelstraße 60
 50996 Köln, Germany

pfm medical inc.
 1815 Aston Ave., Suite 106
 Carlsbad, CA 92008